

USER MANUAL



Wi-Fi pulse counter

supla LIW-01

NETWORK PASSWORD
Choose a WiFi network to enable Internet connectivity for the device. Enter the network password and tap "Next" to continue.

CONNECTING THE DEVICE
Wire the power supply to the device as shown in the diagram. Make sure that the device STATUS LED responds as shown in the animation on screen. If it does not, switch the device into the configuration mode by holding the CONFIG button on the device. Next, press the START button.

NEW DEVICE REGISTRATION DISABLED
If the "New Device Registration Disabled" message is displayed, open this website:
<https://cloud.supla.org/>,
log into your account, go to the "My SUPLA" tab and Enable Device Registration. Next, repeat the device adding process.

CAUTION!
If the connected device is not shown on the list immediately once the configuration is complete, check the device STATUS LED. When added for the first time, the STATUS LED of some devices may flash very fast and irregularly. This happens when the device controller is updating its firmware. A moment after the update, the STATUS LED should go on steadily which means there is an active connection with the server.

CAUTION!
If the connected device is not shown on the list immediately once the configuration is complete, check the device STATUS LED. When added for the first time, the STATUS LED of some devices may flash very fast and irregularly. This happens when the device controller is updating its firmware. A moment after the update, the STATUS LED should go on steadily which means there is an active connection with the server.

CAUTION!
If the connected device is not shown on the list immediately once the configuration is complete, check the device STATUS LED. When added for the first time, the STATUS LED of some devices may flash very fast and irregularly. This happens when the device controller is updating its firmware. A moment after the update, the STATUS LED should go on steadily which means there is an active connection with the server.

CAUTION!
If the connected device is not shown on the list immediately once the configuration is complete, check the device STATUS LED. When added for the first time, the STATUS LED of some devices may flash very fast and irregularly. This happens when the device controller is updating its firmware. A moment after the update, the STATUS LED should go on steadily which means there is an active connection with the server.

CAUTION!
If the connected device is not shown on the list immediately once the configuration is complete, check the device STATUS LED. When added for the first time, the STATUS LED of some devices may flash very fast and irregularly. This happens when the device controller is updating its firmware. A moment after the update, the STATUS LED should go on steadily which means there is an active connection with the server.

CAUTION!
If the connected device is not shown on the list immediately once the configuration is complete, check the device STATUS LED. When added for the first time, the STATUS LED of some devices may flash very fast and irregularly. This happens when the device controller is updating its firmware. A moment after the update, the STATUS LED should go on steadily which means there is an active connection with the server.

CAUTION!
If the connected device is not shown on the list immediately once the configuration is complete, check the device STATUS LED. When added for the first time, the STATUS LED of some devices may flash very fast and irregularly. This happens when the device controller is updating its firmware. A moment after the update, the STATUS LED should go on steadily which means there is an active connection with the server.

CAUTION!
If the connected device is not shown on the list immediately once the configuration is complete, check the device STATUS LED. When added for the first time, the STATUS LED of some devices may flash very fast and irregularly. This happens when the device controller is updating its firmware. A moment after the update, the STATUS LED should go on steadily which means there is an active connection with the server.

CAUTION!
If the connected device is not shown on the list immediately once the configuration is complete, check the device STATUS LED. When added for the first time, the STATUS LED of some devices may flash very fast and irregularly. This happens when the device controller is updating its firmware. A moment after the update, the STATUS LED should go on steadily which means there is an active connection with the server.

CAUTION!
If the connected device is not shown on the list immediately once the configuration is complete, check the device STATUS LED. When added for the first time, the STATUS LED of some devices may flash very fast and irregularly. This happens when the device controller is updating its firmware. A moment after the update, the STATUS LED should go on steadily which means there is an active connection with the server.

CAUTION!
If the connected device is not shown on the list immediately once the configuration is complete, check the device STATUS LED. When added for the first time, the STATUS LED of some devices may flash very fast and irregularly. This happens when the device controller is updating its firmware. A moment after the update, the STATUS LED should go on steadily which means there is an active connection with the server.

CAUTION!
If the connected device is not shown on the list immediately once the configuration is complete, check the device STATUS LED. When added for the first time, the STATUS LED of some devices may flash very fast and irregularly. This happens when the device controller is updating its firmware. A moment after the update, the STATUS LED should go on steadily which means there is an active connection with the server.

CAUTION!
If the connected device is not shown on the list immediately once the configuration is complete, check the device STATUS LED. When added for the first time, the STATUS LED of some devices may flash very fast and irregularly. This happens when the device controller is updating its firmware. A moment after the update, the STATUS LED should go on steadily which means there is an active connection with the server.

CAUTION!
If the connected device is not shown on the list immediately once the configuration is complete, check the device STATUS LED. When added for the first time, the STATUS LED of some devices may flash very fast and irregularly. This happens when the device controller is updating its firmware. A moment after the update, the STATUS LED should go on steadily which means there is an active connection with the server.

CAUTION!
If the connected device is not shown on the list immediately once the configuration is complete, check the device STATUS LED. When added for the first time, the STATUS LED of some devices may flash very fast and irregularly. This happens when the device controller is updating its firmware. A moment after the update, the STATUS LED should go on steadily which means there is an active connection with the server.

CAUTION!
If the connected device is not shown on the list immediately once the configuration is complete, check the device STATUS LED. When added for the first time, the STATUS LED of some devices may flash very fast and irregularly. This happens when the device controller is updating its firmware. A moment after the update, the STATUS LED should go on steadily which means there is an active connection with the server.

CAUTION!
If the connected device is not shown on the list immediately once the configuration is complete, check the device STATUS LED. When added for the first time, the STATUS LED of some devices may flash very fast and irregularly. This happens when the device controller is updating its firmware. A moment after the update, the STATUS LED should go on steadily which means there is an active connection with the server.

CAUTION!
If the connected device is not shown on the list immediately once the configuration is complete, check the device STATUS LED. When added for the first time, the STATUS LED of some devices may flash very fast and irregularly. This happens when the device controller is updating its firmware. A moment after the update, the STATUS LED should go on steadily which means there is an active connection with the server.

CAUTION!
If the connected device is not shown on the list immediately once the configuration is complete, check the device STATUS LED. When added for the first time, the STATUS LED of some devices may flash very fast and irregularly. This happens when the device controller is updating its firmware. A moment after the update, the STATUS LED should go on steadily which means there is an active connection with the server.

1. BEFORE STARTING

PULSE COUNTER FEATURES:

- Universal electrical pulse counter which features a pulse input for metering electricity, water or gas consumption
- Counts the pulse output from pulse modules of utility meters
- Requires 12-24 V AC / DC power supply and simple configuration setup
- Relays / provides access to metering data to / in a cloud

PRODUCT CONTENTS

- LIW-01 device
- User manual

WHAT YOU NEED TO START

- Access to the local distribution panel
- Power adapter, a screwdriver, and lineman's pliers
- Cable with max. 2.5 mm² core size to wire the power supply source
- Recommended: electrician's license for 1 kV systems
- **12-24 V DC power adapter** or a **12-24 V AC power transformer**

2. WARNING!



CAUTION

The device must be connected to power supply in accordance with applicable electrical and safety standards or regulations. See this User Manual for the wiring instructions. Installation, wiring and setting of this product shall only be done by qualified electrical engineers who have read and understood this User Manual and the product features. Do not open or otherwise disassemble the product enclosure; otherwise the product warranty will be void and an electrocution hazard may occur. Prior to installing and wiring this product, make sure that the wiring to be connected is live. The conditions and methods of transport, storage and operation of this product may affect its performance. Do not install the product if any of its components is missing, the product is damaged or deformed in any way. If any malfunctions are found, consult the manufacturer.

ZAMEL Sp. z o.o. hereby declares that the radio-frequency (RF) device type LIW-01 conforms to Directive 2014/53/EU. See the website below for the Full EU Declaration of Conformity: www.zamel.com

3. NOTICE

When installing this product, verify that this device is not directly exposed to water or operation at high relative humidity. The temperature at the installation site must be between -10°C and +55°C.

The LIW-01 RF receiver is intended for indoor installation. If installed outdoors, place this device in an external water-tight enclosure and secure against ingress of water, especially at the wiring terminals.

4. TECHNICAL SPECIFICATIONS

LIW-01	
Rated voltage:	12-24 V AC / DC
Voltage tolerance:	>20 % to +15 %
Rated input power:	0.8 W
Main frequency:	50 / 60 Hz
Pulse input:	Operating voltage 9 V, compatible with EN 62053-31 SO pulse outputs of electrical power meters or OC dry contact pulse outputs
Operating temperature:	-10°C to +55°C
Optical status indication:	LED
Protection rating:	IP20
Connection terminals:	4 (for max. 2.5 mm ² wires)
Enclosure installation:	DIN TH-35 rail
RF transmission:	Wi-Fi 2.4GHz 802.11 b/g/n
Transmission range:	Wi-Fi range
Dimensions:	90 x 17.5 x 66 mm
Weight:	0,050 kg

5. GETTING STARTED IN 5 STEPS

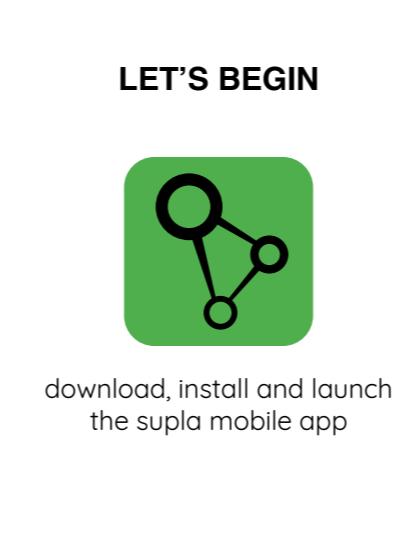

LET'S BEGIN

download, install and launch the supla mobile app

STEP 2 create an account / log in

IF YOU DO NOT HAVE AN ACCOUNT Create it by tapping "Create Account" in your app.

IF YOU ALREADY HAVE AN ACCOUNT Enter the e-mail address which you have used to create the account.

Confirm all information by tapping "Create an account".

Confirm all information by tapping "Create an account".

Confirm all information by tapping "Create an account".

Confirm all information by tapping "Create an account".

Confirm all information by tapping "Create an account".

Confirm all information by tapping "Create an account".

Confirm all information by tapping "Create an account".

Confirm all information by tapping "Create an account".

Confirm all information by tapping "Create an account".

Confirm all information by tapping "Create an account".

Confirm all information by tapping "Create an account".

Confirm all information by tapping "Create an account".

Confirm all information by tapping "Create an account".

Confirm all information by tapping "Create an account".

Confirm all information by tapping "Create an account".

Confirm all information by tapping "Create an account".

Confirm all information by tapping "Create an account".

Confirm all information by tapping "Create an account".

Confirm all information by tapping "Create an account".

Confirm all information by tapping "Create an account".

Confirm all information by tapping "Create an account".

Confirm all information by tapping "Create an account".

Confirm all information by tapping "Create an account".

Confirm all information by tapping "Create an account".

Confirm all information by tapping "Create an account".

Confirm all information by tapping "Create an account".

Confirm all information by tapping "Create an account".

Confirm all information by tapping "Create an account".

Confirm all information by tapping "Create an account".

Confirm all information by tapping "Create an account".

Confirm all information by tapping "Create an account".

Confirm all information by tapping "Create an account".

Confirm all information by tapping "Create an account".

Confirm all information by tapping "Create an account".

Confirm all information by tapping "Create an account".

Confirm all information by tapping "Create an account".

Confirm all information by tapping "Create an account".

Confirm all information by tapping "Create an account".

Confirm all information by tapping "Create an account".

Confirm all information by tapping "Create an account".

Confirm all information by tapping "Create an account".

Confirm all information by tapping "Create an account".

Confirm all information by tapping "Create an account".

Confirm all information by tapping "Create an account".

Confirm all information by tapping "Create an account".

Confirm all information by tapping "Create an account".

Confirm all information by tapping "Create an account".

Confirm all information by tapping "Create an account".

Confirm all information by tapping "Create an account".

Confirm all information by tapping "Create an account".

Confirm all information by tapping "Create an account".

Confirm all information by tapping "Create an account".

Confirm all information by tapping "Create an account".

Confirm all information by tapping "Create an account".

Confirm all information by tapping "Create an account".

Confirm all information by tapping "Create an account".

Confirm all information by tapping "Create an account".

Confirm all information by tapping "Create an account".

Confirm all information by tapping "Create an account".

Confirm all information by tapping "Create an account".

Confirm all information by tapping "Create an account".

Confirm all information by tapping "Create an account".

Confirm all information by tapping "Create an account".

Confirm all information by tapping "Create an account".

Confirm all information by tapping "Create an account".

Confirm all information by tapping "Create an account".

Confirm all information by tapping "Create an account".

Confirm all information by tapping "Create an account".

Confirm all information by tapping "Create an account".

5.1. INSTALL THE SUPLA MOBILE APP



STEP 2 create an account / log in

IF YOU DO NOT HAVE AN ACCOUNT Create it by tapping "Create Account" in your app.

IF YOU ALREADY HAVE AN ACCOUNT Enter the e-mail address which you have used to create the account.

Confirm all information by tapping "Create an account".

Confirm all information by tapping "Create an account".

Confirm all information by tapping "Create an account".

Confirm all information by tapping "Create an account".

Confirm all information by tapping "Create an account".

Confirm all information by tapping "Create an account".

Confirm all information by tapping "Create an account".

Confirm all information by tapping "Create an account".

Confirm all information by tapping "Create an account".

Confirm all information by tapping "Create an account".

Confirm all information by tapping "Create an account".

Confirm all information by tapping "Create an account".

Confirm all information by tapping "Create an account".

Confirm all information by tapping "Create an account".

Confirm all information by tapping "Create an account".

Confirm all information by tapping "Create an account".

Confirm all information by tapping "Create an account".

Confirm all information by tapping "Create an account".

Confirm all information by tapping "Create an account".

Confirm all information by tapping "Create an account".

Confirm all information by tapping "Create an account".

Confirm all information by tapping "Create an account".

Confirm all information by tapping "Create an account".

Confirm all information by tapping "Create an account".

Confirm all information by tapping "Create an account".

Confirm all information by tapping "Create an account".

Confirm all information by tapping "Create an account".

Confirm all information by tapping "Create an account".

Confirm all information by tapping "Create an account".

Confirm all information by tapping "Create an account".

Confirm all information by tapping "Create an account".

Confirm all information by tapping "Create an account".

Confirm all information by tapping "Create an account".

Confirm all information by tapping "Create an account".

Confirm all information by tapping "Create an account".

Confirm all information by tapping "Create an account".

Confirm all information by tapping "Create an account".

Confirm all information by tapping "Create an account".

Confirm all information by tapping "Create an account".

Confirm all information by tapping "Create an account".

Confirm all information by tapping "Create an account".

Confirm all information by tapping "Create an account".

Confirm all information by tapping "Create an account".

Confirm all information by tapping "Create an account".

Confirm all information by tapping "Create an account".

Confirm all information by tapping "Create an account".

Confirm all information by tapping "Create an account".

Confirm all information by tapping "Create an account".

Confirm all information by tapping "Create an account".

Confirm all information by tapping "Create an account".

Confirm all information by tapping "Create an account".

Confirm all information by tapping "Create an account".

Confirm all information by tapping "Create an account".

Confirm all information by tapping "Create an account".

Confirm all information by tapping "Create an account".

Confirm all information by tapping "Create an account".

Confirm all information by tapping "Create an account".

Confirm all information by tapping "Create an account".

Confirm all information by tapping "Create an account".

Confirm all information by tapping "Create an account".

Confirm all information by tapping "Create an account".

Confirm all information by tapping "Create an account".

Confirm all information by tapping "Create an account".

Confirm all information by tapping "Create an account".

Confirm all information by tapping "Create an account".

Confirm all information by tapping "Create an account".

Confirm all information by tapping "Create an account".

Confirm all information by tapping "Create an account".

Confirm all information by tapping "Create an account".

Confirm all information by tapping "Create an account".

Confirm all information by tapping "Create an account".

5.2. CREATING A SUPLA ACCOUNT

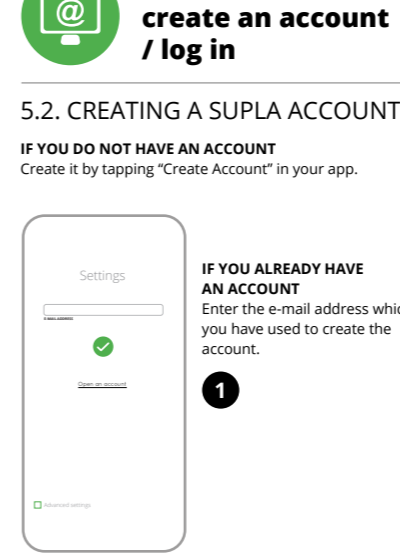

STEP 3 connect the power input wiring

Wire the LIW-01 to the power supply system as shown in the diagram.

IF YOU DO NOT HAVE AN ACCOUNT Create it by tapping "Create Account" in your app.

IF YOU ALREADY HAVE AN ACCOUNT Enter the e-mail address which you have used to create the account.

Confirm all information by tapping "Create an account".

Confirm all information by tapping "Create an account".

Confirm all information by tapping "Create an account".

Confirm all information by tapping "Create an account".

Confirm all information by tapping "Create an account".

Confirm all information by tapping "Create an account".

Confirm all information by tapping "Create an account".

Confirm all information by tapping "Create an account".

Confirm all information by tapping "Create an account".

Confirm all information by tapping "Create an account".

Confirm all information by tapping "Create an account".

Confirm all information by tapping "Create an account".

Confirm all information by tapping "Create an account".

Confirm all information by tapping "Create an account".

Confirm all information by tapping "Create an account".

